



PB07

Rating: 0.1A 30V DC

Contact Resistance: 100mΩ Max

Insulation Resistance:DC 500V 100MΩ Min

Dielectric Strength:AC 250V for 1 minute

Total travel:2.5±0.3mm

Operating Force:200±50gf

Operating Life:50,000 cycles

Operating Temperature:0°C~60°C

Function:OFF-(ON)

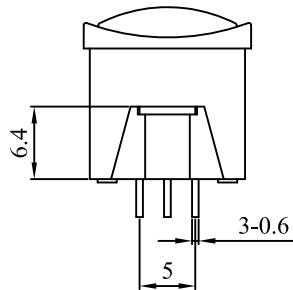
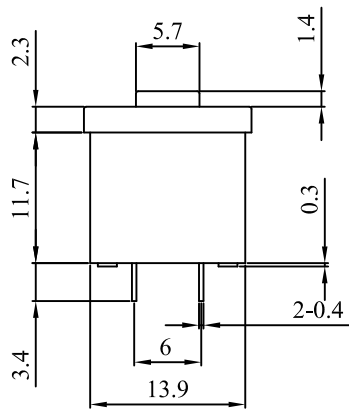
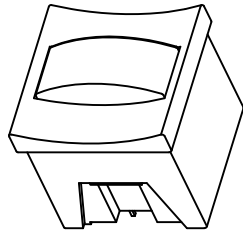
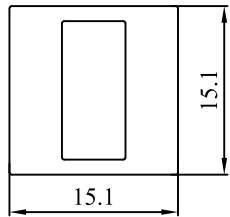

Contact Configuration:

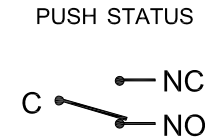
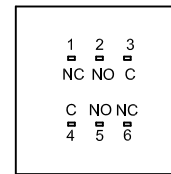
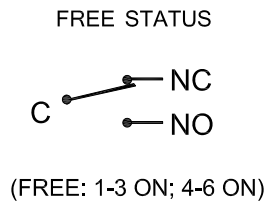

(PUSH: 2-3 ON; 4-5 ON)

(FREE: 1-3 ON; 4-6 ON)

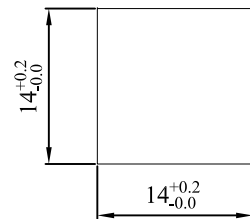

PANEL HOLE

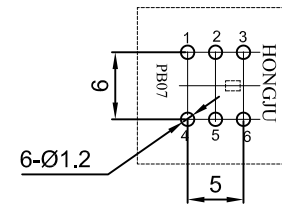

PCB HOLE(BOTTON VIEW)

MATERIAL:

Outer Frame: ABS;

Base: ABS;

Actuator: ABS;

Terminal:Brass,Silver or Tin plated.

Y	Yellow 黄色
W	White 白色
U	Blue 蓝色
R	Red 红色
O	Orange 橙色
G	Green 绿色
B	Black 黑色
A	Gray 灰色
CAP COLOR (X)	

		公差 TOLEANCES		.X± 0.3	.XX± 0.15	角度	± 1°	单位 DIMENSION UNIT mm.	
		版本 VERSION	A1	比例尺 SCALE	NONE	日期 DATE	2020.08.27	品名 TITLE	图号 DRAWING NO
		核准 APPROVED BY		核对 CHECKED BY	Z. H. B.	绘图 DRAWN BY	Z. H. B.	PB07-RA-0N0	PB07-RA-0N0_A1
版本 VER.	变更说明 CHANGE DESCRIPTION	日期 DATE	ECN NO.	APPROVED BY	CHECKED BY	DRAWN BY	Z. H. B.		